

ALASKA

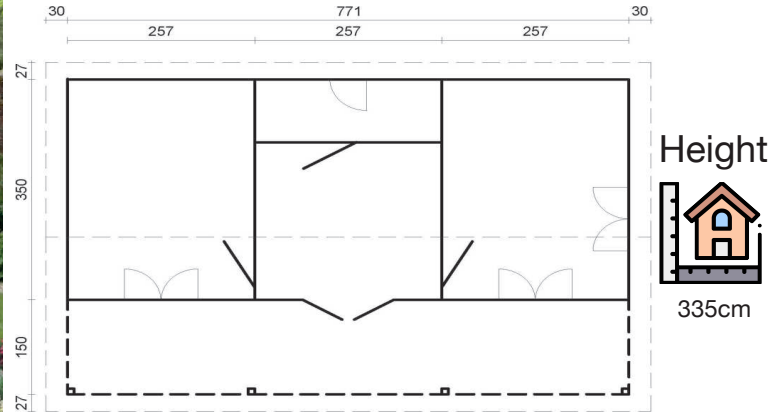

Who needs an overseas holiday when you could spend the summer in the Alaska log cabin summer house? With three rooms, decking and space for a toilet and washroom, it could serve very well as a holiday cabin, sports pavilion or a community social room.



791 x 370
(520)cm



44mm



75.2+31.0m³



25.6+11.1m²



Door
Opening*



Window
Opening*



19mm



19mm



177cm

FULL SPECIFICATION

CABIN SIZE:	791 x 370(520)cm x 335cm	Wood Type:	Nordic Spruce
WALL THICKNESS:	44mm	Chalet Cut:	Logs (Wind & Rain Protection)
VOLUME:	75.2+31.0m ³	Window Type:	Double Glass
AREA:	25.6+11.1m ²	Window / Door Feature:	Rubber Seals & Silicone
DOOR OPENING:	60 x 187, 73 x 187, 151 x 186cm	Braces:	Wind Braces
WINDOW OPENING:	44 x 44, 119 x 117 (3)cm	Roof Boards With:	Boards With Tongue & Groove
FLOORS BOARDS:	19mm	Guarantee:	5 Years
ROOF BOARDS:	19mm	Treated Foundation Joists:	Yes
ROOF OVERHANG:	177cm	IDEAL FOR:	Log Cottages
UNDER PLANNING:	No		

FROM £16,153

**FINANCE FROM
£150.63PCM**

